

AIRREX PORTABLE  
AIR CONDITIONER

# HSC-12

**New Model**

**\*Using Up-graded Core Technology and New Innovations by AIRREX! AIRREX has launched convenient Duct & Louver Grille changeable model HSC-12.**

Airrex spot coolers operate in air temperature from 72°F to 113°F. These air conditioners utilize eco-friendly R-410A refrigerant. Airrex spot cooler air conditioner may require a fresh air supply for proper operation. Includes removable, washable air filters for easy maintenance. Thermostatically protected compressor includes high and low pressure warnings. Moves easily on swivel casters (2 locking), 5" diameter front cold air discharge and 10" diameter top warm air discharge.

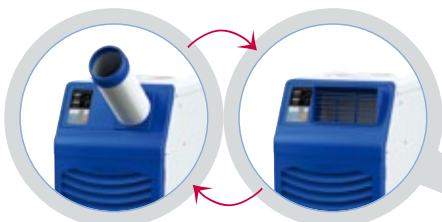

**\*Convenient Changeable 2Way Duct & Grille type**

- › Duct type: Directed cooling to the places and the persons
- › Grill type: Cooling to the indoor whole places



**\*Hot Air Exhaust**

- › Flat type Condenser hot air outlet
- › Operating Range : Up to 122°F



**\*Easy Ventilation of Condenser Warm Air**

- › 10" Diameter Condenser outlet



**\*Convenient Digital Controller**

- › Programmable Timer
- › Temperature Range : 50°F~86°F
- › High/Low Fan Speed
- › Auto Restart



**\*Easily Controlled Lockable Wheel**

- › Durable, Strong Urethane 3 inch Casters (2 Locking)



**\*Condensate Tank**

- › Excellent condensate water sensing using Proximity Sensor
- › Efficient 4 Gal Built-in Water tank
- › Auto Condensate Pump (Option)

**\*Strong Point**

- 2 Steps Air Amount Control (High/Low)
- Remote Controller
- By Using High efficiency and performance BLDC Motor, Energy saving
- Off Timer (1~24hr)
- Advanced Design with Plastic Housing
- Low Noise Design

**\*Specifications**

Items	Unit	HSC-12
Cooling capacity	BTU/h	12,000
Power Supply	Volts	115V~, 60Hz, 1Ph
Size (W×D×H)	inch.	16,5×24,4×42,2
Weight	lbs	132
Current Consumption (AMPS)	A	12,8
Circuit Breaker Size (AMPS)	A	15
Rated Power Consumption (Cooling)	kW	1,47
Compressor Input	kW	1,22
Air Flow (CMP, High/Low) Evaporator	CFM	412/362
Motor Input	kW	0,23
Air Filter		Vinyl Chloride
Nema Plug		5-15
Safety Device		<ul style="list-style-type: none"> <li>• High/Low Pressure Switch</li> <li>• Fan Motor Protection</li> <li>• 3min. Delay Timer</li> <li>• Automatic Full Tank Shut-Off</li> <li>• Thermostat Protector for Compressor</li> </ul>
Power Cord	type	Plug Type
Power Cord Length	ft	6,6
Refrigerant	lbs	R-410A(1,43)
Operating Conditions	°F	72°F DB 60%RH ~ 113°F DB 40%RH
Remarks		-

The specification and design of the product above are subject to change for the performance improvement without notice.

**\*Ideal Applications for Airrex Portable Air Conditioner**



- Industrial Sites** > Temperature Work Sites, Car Manufacturing, Plants, Ship Building Yards, and Steel Mills.
- Repair Shops** > Car Repair Shops, Aircraft Workshops, Farm Machinery Workshops, Gas Stations, and Parking Facilities
- Heat Generating Equipment** > Server Rooms and Machine Rooms
- Leisure/Outdoor Event Venues**
- Farm & Livestock Ranges**